



Centrifugal Sanitary Pumps

CR series

Standard design

Centrifugal pumps incorporating a special auger type screw shaped impeller, which is ideal for the gentle handling of very delicate fluids and large soft solids in suspension.

Wetted parts in investment cast CF-3M 1.4404 / AISI 316L stainless steel, electro-chemically polished to ensure the perfect surface finish.

Separate IEC standard motor:
Stainless steel shroud and adjustable feet on request.

Flow rates range from 0 to 150 m³ /h, heads up to 20 m (2 bar).

The clamp casing and seal design allows quick disassembly for inspection, cleaning and maintenance. It also enables the delivery port to be rotated to any position for easy installation.

Seals:

Mechanical seals seats to EN 12756, ISO 3069 standards.
Single internal mechanical seal
Single external mechanical seal
Double flushed mechanical seal

Elastomers (certified to FDA):

EPDM
Fluorocarbon (Viton)
Silicone
P.T.F.E. (FEP)

Connections:

DIN - SMS - IDF - BS / RJT - DS - CLAMP and EN 1092-1
PN16 flanges to suit most international standards.

Applications

Delicate handling without clogging.
The CR Series has been designed for very gentle handling of sensitive media at extremely low flow velocities. The screw shape impeller combines the properties of a centrifugal pump with the delicate characteristics of a positive displacement pump. The ability to handle high solids products in an extremely gentle way makes CR Series pumps ideal for food processing.

- Fruit and vegetable handling
- Soups and sauces
- Cereals
- Fish transportation
- Food pastes
- Oil
- Wine recirculation

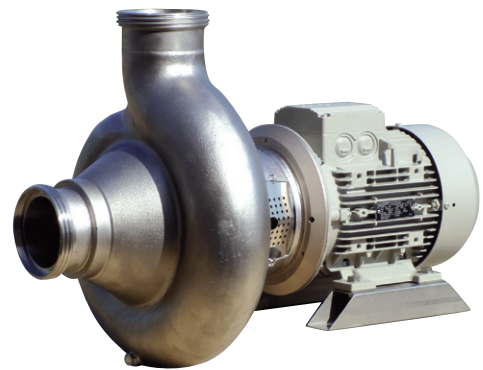

CR pump



CR pump with shroud

GENERAL DIAGRAMS

POMPA TIPO <i>Pump type</i>		CR 65			n 920/1110	giri / min <i>r. p. m.</i>
GIRANTE — Impeller						
TIPO <i>Type</i>	N° di pale <i>n° of vanes</i>	Pass. sferico <i>max. sphere</i>	Ø max <i>max. diameter</i>	Ø min <i>min. diameter</i>	Bocche tipo <i>Ports type</i>	Bocca aspir. <i>Suction port</i>
APERTA	1 Elica	33 mm	156 mm	— mm	DIN 11851	DN 65
					Bocca mand. <i>Discharge port</i>	DN 65
CARATTERISTICHE DI FUNZIONAMENTO CON ACQUA PULITA A 20°C - PESO SPECIFICO 1 (kg/dm ³) <i>Curves show performance with clear water at 70°F - Specific gravity 1 (kg/dm³)</i>						

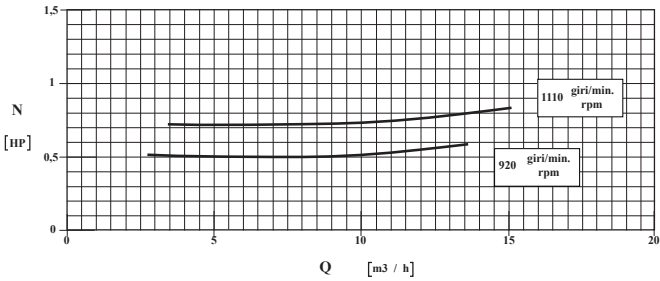
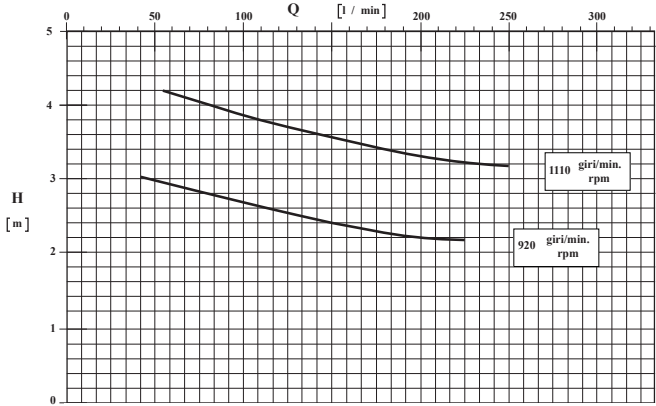

POMPA TIPO <i>Pump type</i>		CR 80			n 960/1150	giri / min <i>r. p. m.</i>
GIRANTE — Impeller						
TIPO <i>Type</i>	N° di pale <i>n° of vanes</i>	Pass. sferico <i>max. sphere</i>	Ø max <i>max. diameter</i>	Ø min <i>min. diameter</i>	Bocche tipo <i>Ports type</i>	Bocca aspir. <i>Suction port</i>
APERTA	1 Elica	45 mm	178 mm	— mm	DIN 11851	DN 80
					Bocca mand. <i>Discharge port</i>	DN 80
CARATTERISTICHE DI FUNZIONAMENTO CON ACQUA PULITA A 20°C - PESO SPECIFICO 1 (kg/dm ³) <i>Curves show performance with clear water at 70°F - Specific gravity 1 (kg/dm³)</i>						

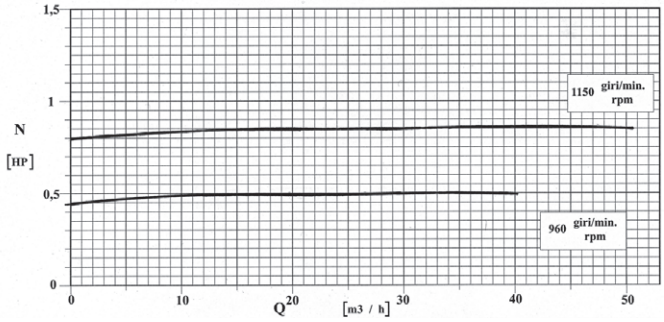
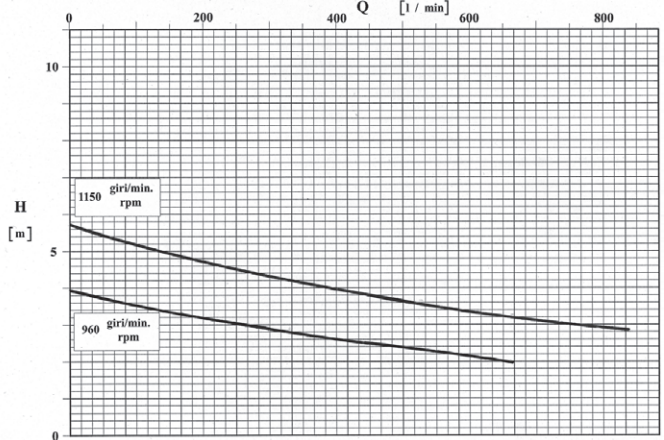

POMPA TIPO <i>Pump type</i>		CR 100			n 960/1150	giri / min <i>r. p. m.</i>
GIRANTE — Impeller						
TIPO <i>Type</i>	N° di pale <i>n° of vanes</i>	Pass. sferico <i>max. sphere</i>	Ø max <i>max. diameter</i>	Ø min <i>min. diameter</i>	Bocche tipo <i>Ports type</i>	Bocca aspir. <i>Suction port</i>
APERTA	1 Elica	58 mm	210 mm	— mm	DIN 11851	DN 100
					Bocca mand. <i>Discharge port</i>	DN 100
CARATTERISTICHE DI FUNZIONAMENTO CON ACQUA PULITA A 20°C - PESO SPECIFICO 1 (kg/dm ³) <i>Curves show performance with clear water at 70°F - Specific gravity 1 (kg/dm³)</i>						

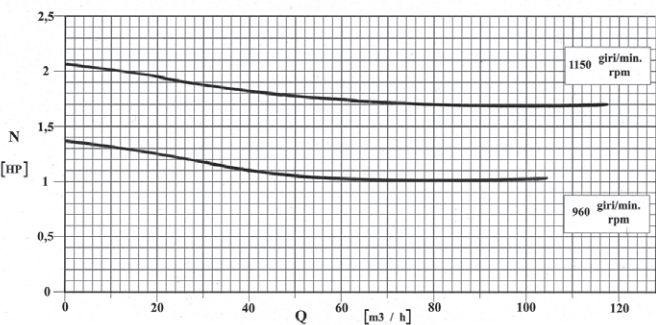
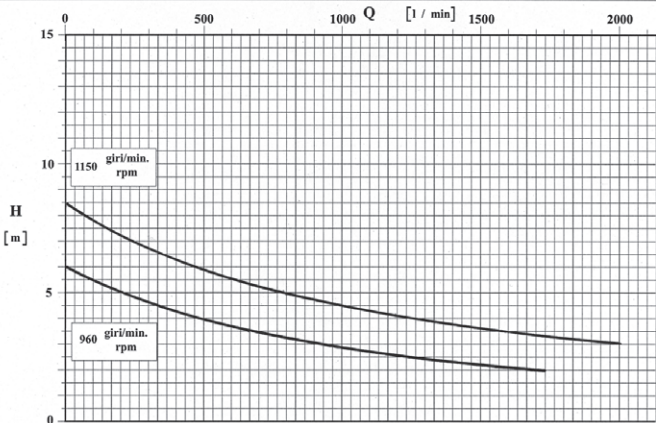

POMPA TIPO <i>Pump type</i>		CR 125			n 960/1150	giri / min <i>r. p. m.</i>
GIRANTE — Impeller						
TIPO <i>Type</i>	N° di pale <i>n° of vanes</i>	Pass. sferico <i>max. sphere</i>	Ø max <i>max. diameter</i>	Ø min <i>min. diameter</i>	Bocche tipo <i>Ports type</i>	Bocca aspir. <i>Suction port</i>
APERTA	1 Elica	63 mm	260 mm	— mm	DIN 11851	DN 125
					Bocca mand. <i>Discharge port</i>	DN 125
CARATTERISTICHE DI FUNZIONAMENTO CON ACQUA PULITA A 20°C - PESO SPECIFICO 1 (kg/dm ³) <i>Curves show performance with clear water at 70°F - Specific gravity 1 (kg/dm³)</i>						

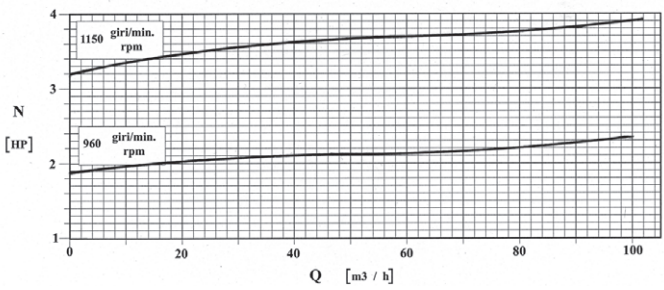
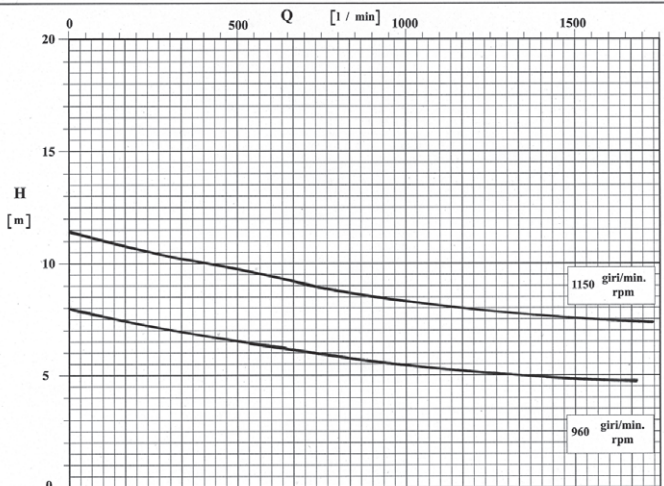

GENERAL DIAGRAMS

POMPA TIPO		CR 65			n 1400/1750 giri / min r. p. m.	
GIRANTE — Impeller						
TIPO Type	N° di pale n° of vanes	Pass. sferico max. sphere	Ø max max. diameter	Ø min min. diameter	Bocche tipo Ports type	Bocca aspir. Suction port
APERTA	1 Elica	33 mm	156 mm	---	DIN 11851	DN 65
					Bocca mand. Discharge port	DN 65
CARATTERISTICHE DI FUNZIONAMENTO CON ACQUA PULITA A 20°C - PESO SPECIFICO 1 (kg/dm³) Curves show performance with clear water at 70°F - Specific gravity 1 (kg/dm ³)						

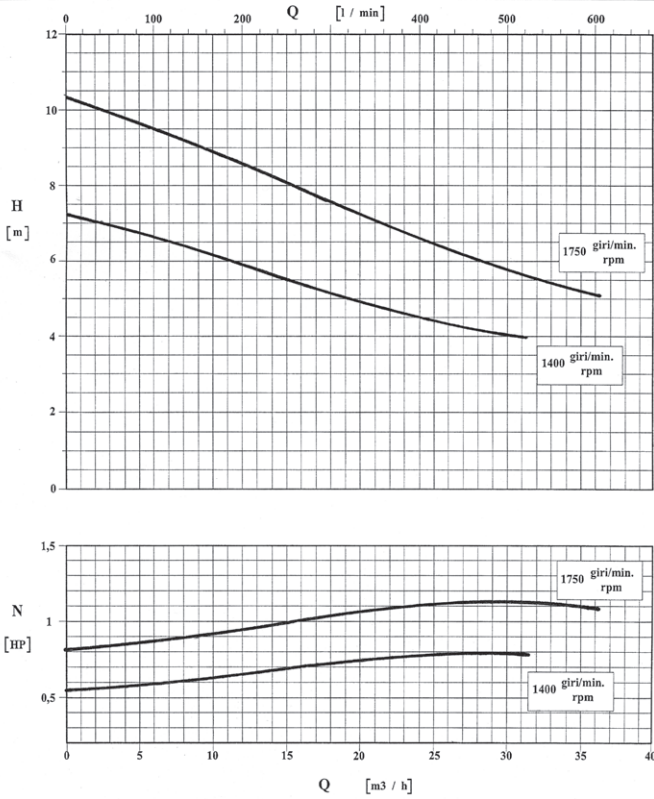

POMPA TIPO		CR 80			n 1450/1750 giri / min r. p. m.	
GIRANTE — Impeller						
TIPO Type	N° di pale n° of vanes	Pass. sferico max. sphere	Ø max max. diameter	Ø min min. diameter	Bocche tipo Ports type	Bocca aspir. Suction port
APERTA	1 Elica	45 mm	178 mm	---	DIN 11851	DN 80
					Bocca mand. Discharge port	DN 80
CARATTERISTICHE DI FUNZIONAMENTO CON ACQUA PULITA A 20°C - PESO SPECIFICO 1 (kg/dm³) Curves show performance with clear water at 70°F - Specific gravity 1 (kg/dm ³)						

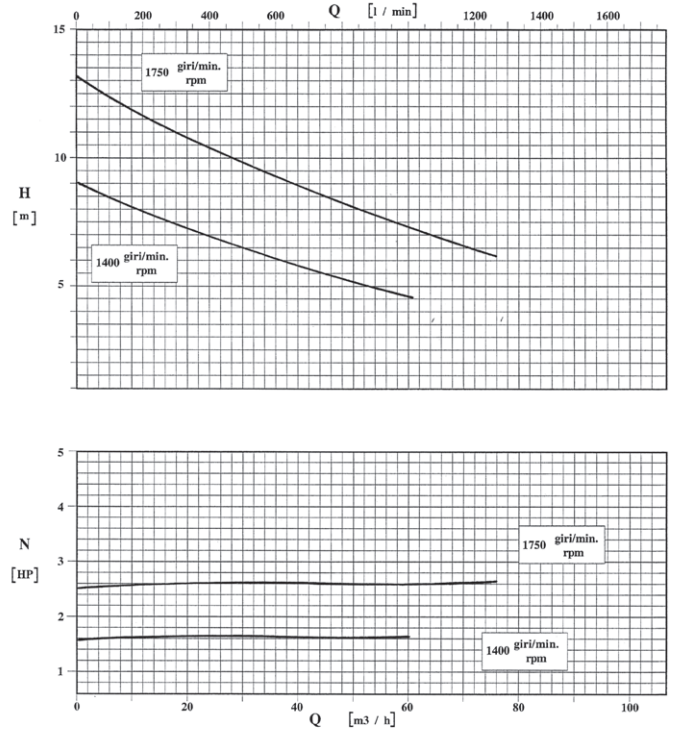

POMPA TIPO		CR 100			n 1450/1750 giri / min r. p. m.	
GIRANTE — Impeller						
TIPO Type	N° di pale n° of vanes	Pass. sferico max. sphere	Ø max max. diameter	Ø min min. diameter	Bocche tipo Ports type	Bocca aspir. Suction port
APERTA	1 Elica	58 mm	210 mm	---	DIN 11851	DN 100
					Bocca mand. Discharge port	DN 100
CARATTERISTICHE DI FUNZIONAMENTO CON ACQUA PULITA A 20°C - PESO SPECIFICO 1 (kg/dm³) Curves show performance with clear water at 70°F - Specific gravity 1 (kg/dm ³)						

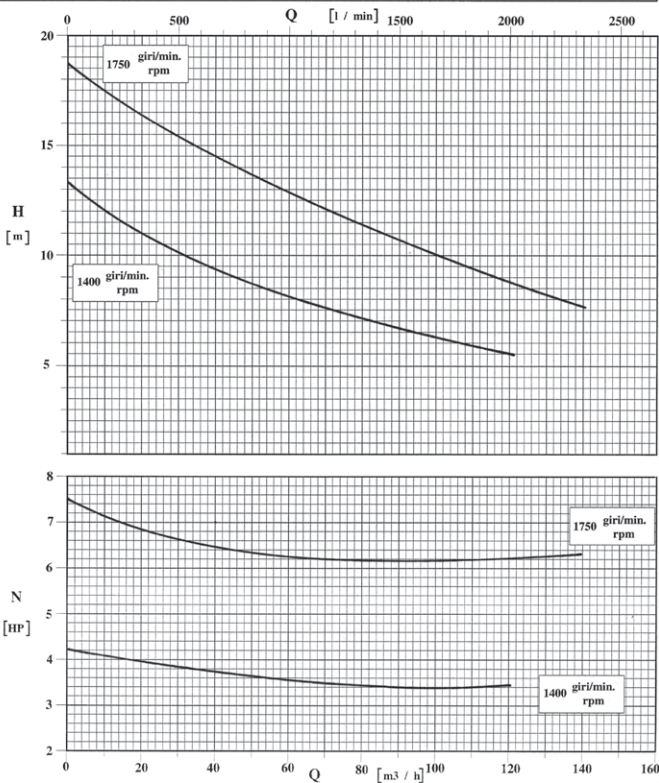

POMPA TIPO		CR 125			n 1450/1750 giri / min r. p. m.	
GIRANTE — Impeller						
TIPO Type	N° di pale n° of vanes	Pass. sferico max. sphere	Ø max max. diameter	Ø min min. diameter	Bocche tipo Ports type	Bocca aspir. Suction port
APERTA	1 Elica	63 mm	260 mm	---	DIN 11851	DN 125
					Bocca mand. Discharge port	DN 125
CARATTERISTICHE DI FUNZIONAMENTO CON ACQUA PULITA A 20°C - PESO SPECIFICO 1 (kg/dm³) Curves show performance with clear water at 70°F - Specific gravity 1 (kg/dm ³)						

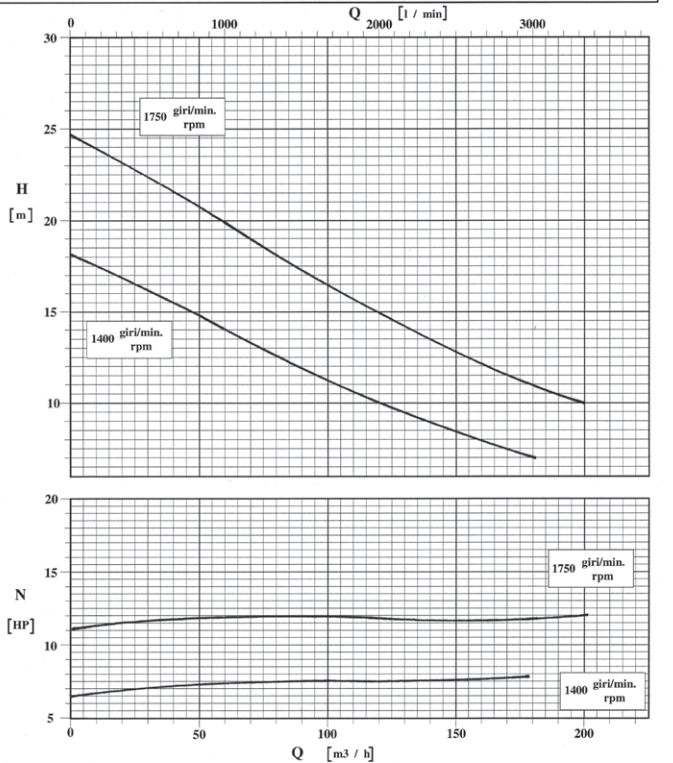

OVERALL DIMENSIONS

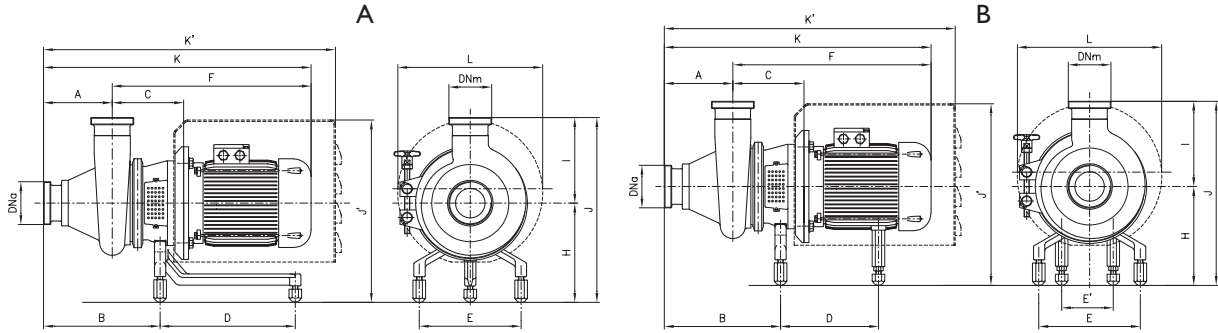

A = motors from 0,55 kW to 4 kW

Dimensions not binding - DN = DIN 11851 male threaded connections, with standard IEC/EN motors

Pumps	rpm	kW	DNa	DNm	A	B	C	D	E	E'	F	H	K	K'	I	J	J'	L
CR 65		1450	0,55 0,75 1,1 1,5	65	65	151	257	158	230	225	-	392	208	543	657	190	398	374
437	588																	
CR 80	1,1 1,5 2,2 3 4		80									80	181	297	168			
508	690	767																
CR 100	2,2 3 4	100	100	205	337	202	300	225	-	536	238	741	824	296	534	443	330	

B = motors from 5,5 kW to 22

Dimensions not binding - DN = DIN 11851 male threaded connections, with standard IEC/EN motors

Pumps	rpm	kW	DNa	DNm	A	B	C	D	E	E'	F	H	K	K'	I	J	J'	L			
CR 100		1450	5,5 7,5 11 15	100	100	205	325	204	283	225	180	576	238	784	848	294	526	460	370		
326	249		408								230			727						247	932
CR 125	5,5 7,5 11 15 18,5 22		125								125	232	370	230	292					225	180
230	748	247		980	1035	593	510														
270	830	1062		1268	579	420															

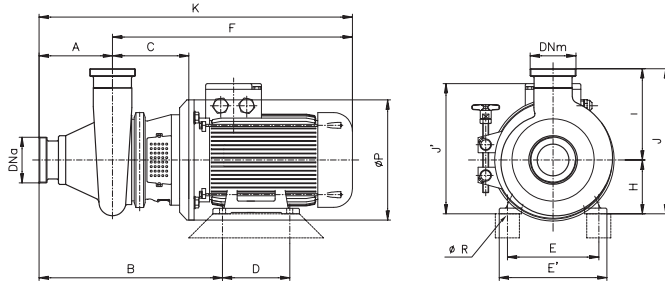

Dimensions not binding - DN = DIN 11851 male threaded connections, with standard IEC/EN motors

Pumps	rpm	kW	DNa	DNm	A	B	C	D	E	E'	F	H	K	I	J	J'	ØP	ØR
CR 65		1450	0,55 0,75 1,1 1,5	65	65	151	360	158	100	125	150	392	80	543	190	270	200	200
362	140		165				437			90	588	280		218				
CR 80	1,1 1,5 2,2 3 4		80				80	181		406	168	125	140	165		452	90	632
413	140	160		196	481	100			663	345		235	250					
CR 100	2,2 3 4 5,5 7,5 11 15	100	100	205	477	202	140	190	240	515	112	720	294	406	331	250	12	
497	178				216		256	576	132	781		426		299	300			
570	257				210	190	240	734	160	937	454	357		350	15			
CR 125	5,5 7,5 11 15 18,5 22	125	125	232	550	230	140	216	256	604	132	836	346	478	404	300	12	
610	178				210		254	300	748	160		980		506	432			
623	241				279	340	830	180	1062	526	499	350		15				



CSF Inox S.p.A. Strada per Bibbiano, 7 - 42027 Montecchio E. (RE) - ITALY EU
Ph +39.0522.869911 | ra. - Fx +39.0522.865454 / 866758 - csfitalia@csf.it - www.csf.it

Export Department • Commercial Étranger • Comercial Extranjero
Ph +39.0522.869922 - Fx +39.0522.869841 - csfexport@csf.it - www.csf.it

All the instructions, data and representations (in whatever way executed) listed in this publication are indicative and do not binding. CSF does not stand surety or undertake any obligation for the utilisation of this document and for the information contained. In particular, it does not guarantee against omissions or errors of the data and drawings here indicated.
Notice that the technical specifications, information and representations in this document are merely indicative and approximate. CSF INOX reserves the right at any moment and without notice to modify the data, drawings and information indicated in this document.